

Ril Lake Land Use Survey, July 2004

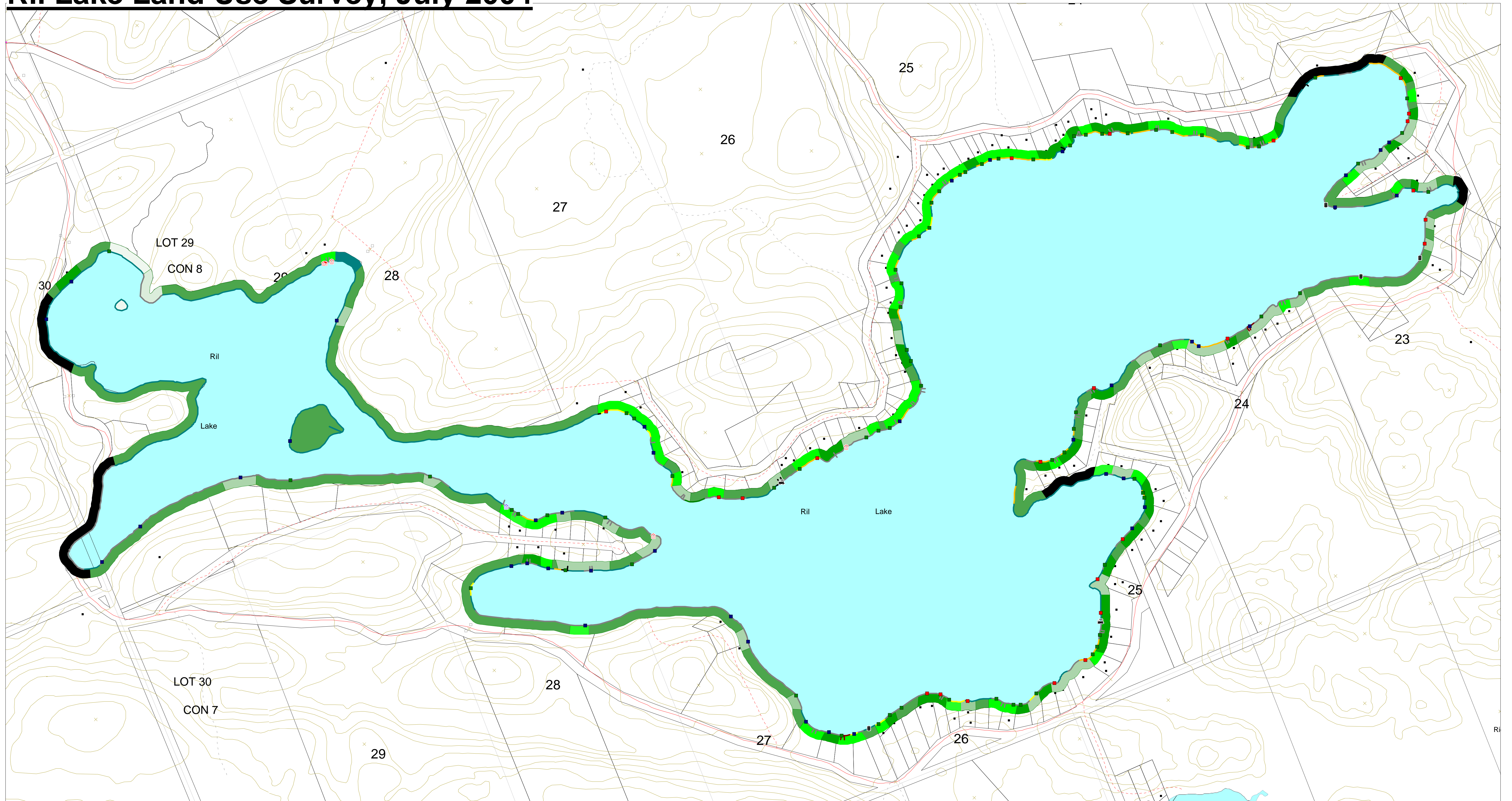

Scale
1 : 4,000
0 0.125 0.25
kilometres



Structure Count

Structure	Type	Count
BHC1	1 Slip Crib Boathouse	3
BHC2	2 Slip Crib Boathouse	1
BHF1	1 Slip Fill Boathouse	1
DC	Crib Dock	24
DFL	Floating Dock	40
DP	Pillar Dock	72
OMR	Marine Railway	2
OSD	Deck	4
	Total	147

Shoreline Length and Percentages

Shoreline	Type	Length_m	Percent
NB	Beach	1,142.31	9.11
NR	Rock	4,309.37	34.38
NS	Shrub	48.92	0.39
NW	Wetland	5,661.15	45.16
OMMB	Man Made Beach	310.93	2.48
RC	Concrete Ramp	17.88	0.14
RS	Gravel Ramp	17.04	0.14
SWC	Concrete Shorewall	52.92	0.42
SWS	Stone Shorewall	933.43	7.45
SWW	Wood Shorewall	41.33	0.33
	Total	12,535.28	100.00
	Natural	11,161.75	89.04
	Altered	1,373.53	10.96
	Structures	407.50	3.25

Backlot Area and Percentages

Backlot	Type	Area_m2	Percent
NFC	Coniferous Forest	2,010.87	0.81
NFM	Mixed Forest	127,441.37	51.16
NFT	Thinned Forest	26,362.93	10.58
NO	Overgrowth	2,822.46	1.13
NS	Shrub	2,506.17	1.01
NW	Wetland	1,252.80	0.50
OR	Road	19,239.47	7.72
YL	Landscaped Yard	3,774.22	1.52
YLB	Buffered Lawn	26,633.74	10.69
YLU	Unbuffered Lawn	37,040.58	14.87
	Total	249,084.61	100.00
	Natural	133,211.21	53.48
	Altered	115,873.40	46.52

Legend

- rli_structures_final by Structure**
- BHC1 (3)
 - BHC2 (1)
 - BHF1 (1)
 - DC (24)
 - DFL (40)
 - DP (72)
 - OMR (2)
 - OSD (4)
- rli_shoreline_final by Shoreline**
- NB (29)
 - NR (29)
 - NS (1)
 - NW (52)
 - OMMB (10)
 - RC (2)
 - RS (1)
 - SWC (3)
 - SWS (30)
 - SWW (2)
- rli_backlot_final by Backlot**
- NFC (1)
 - NFM (50)
 - NFT (23)
 - NO (4)
 - NS (2)
 - NW (1)
 - OR (5)
 - YL (5)
 - YLB (28)
 - YLU (31)



Produced by the District of Muskoka under licence from Ontario Ministry of Natural Resources, Copyright (c) Queens Printer 2004

The information on this map is supplied without expressed or implied warranty of any kind, including any warranty of fitness for a particular purpose.

In no event will the District Municipality of Muskoka be liable for any damages whether incidental, consequential or direct in conjunction with, or arising from the furnishing or use of this information.