

Nutt Lake Land Use Survey, June 2006

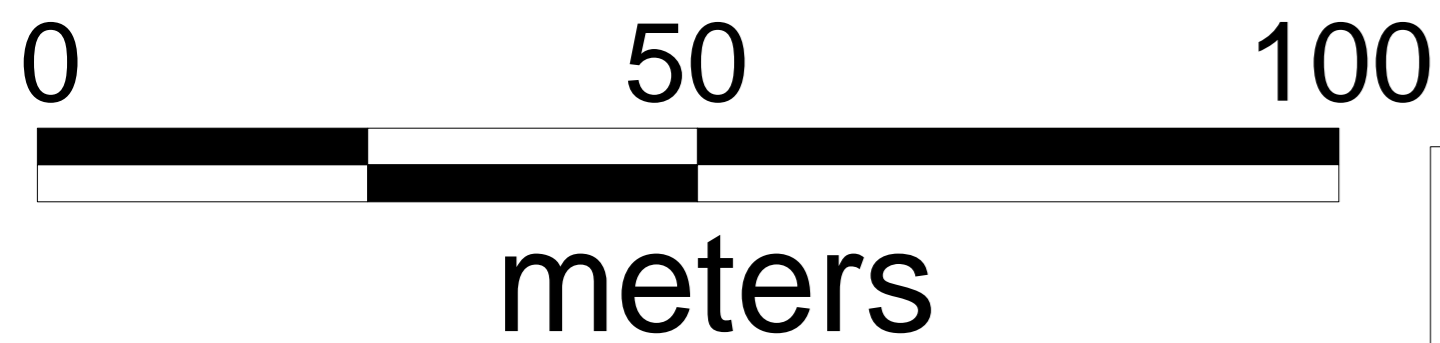
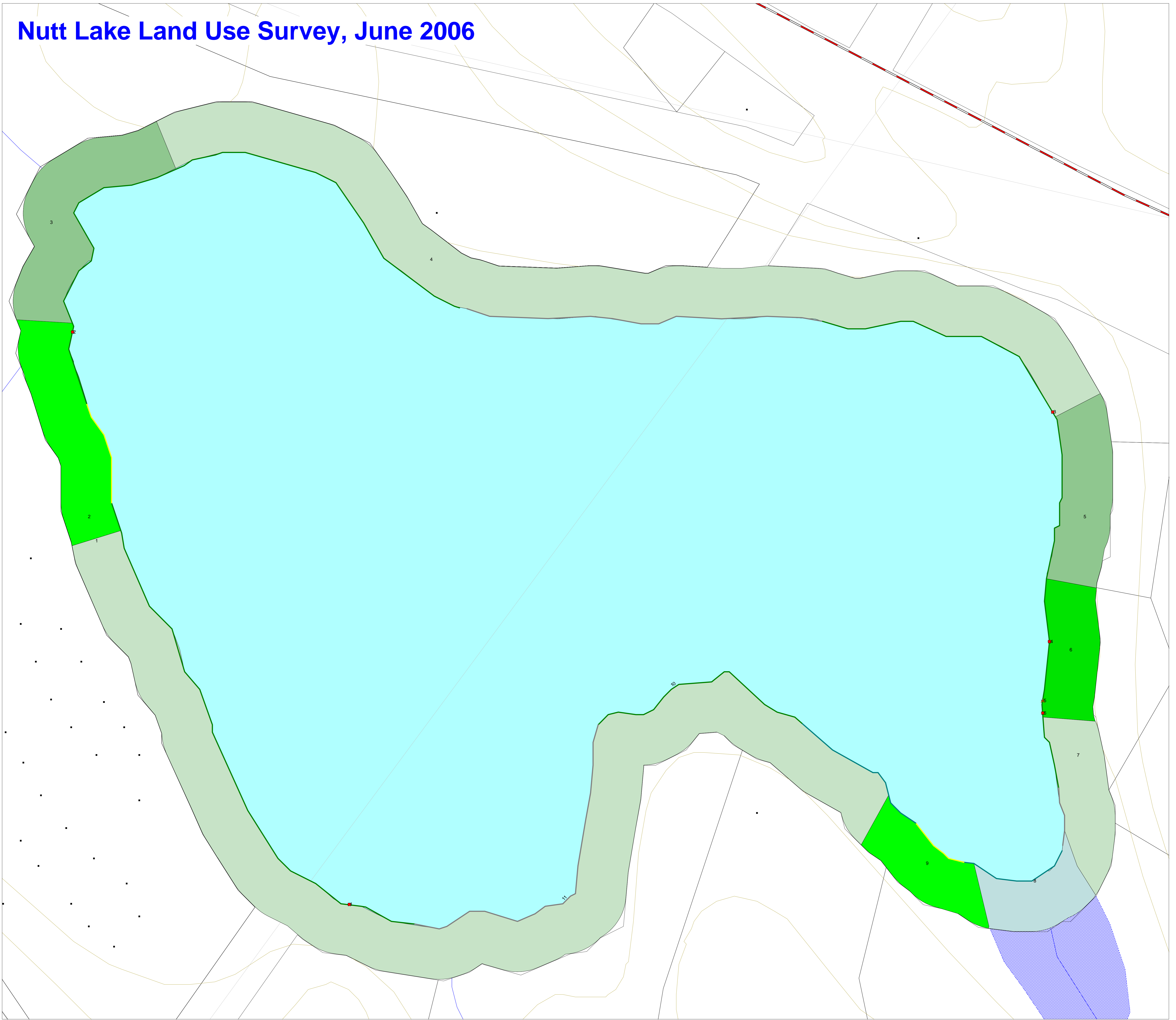

Produced by the District of Muskoka under licence from Ontario Ministry of Natural Resources, Copyright (c) Queens Printer 2006.

The information contained herein may be erroneous, inaccurate or misleading. The parties compiling and/or disclosing the information make no warranties whatsoever as to the accuracy of any or all of the information contained herein.

Any party relying on this information does so at their own risk and shall not, under any circumstances, make any claim against anyone on the grounds that the information was erroneous, inaccurate or misleading.

This road network information has been generated or adapted from Ontario Road Network Database, a database built from source data provided by the Municipalities of Ontario to the Government of Ontario under licence.

The Ontario Road Network Database is the property of the Government of Ontario and is used under licence from the Government of Ontario.

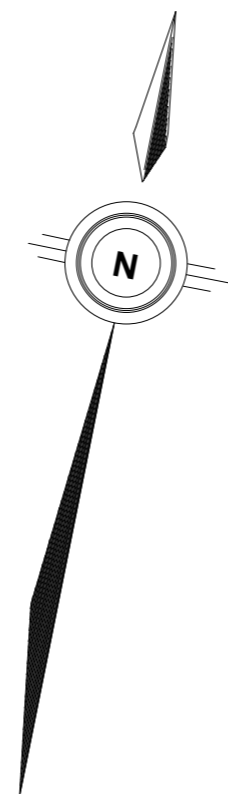

Legend

structurenutmaptab by Structure

- DC (5)
- ▲ OSSC (1)

Structure	Type	Count
DC	Crib Dock	5
OSSC	Sleep Cabin	1
	Total	6

Legend

shorelinenutmap by Shoreline

- NR (3)
- NS (4)
- NW (2)
- OMMB (2)

Shoreline Length and Percentages

Shoreline	Type	Length_m	Percent
NR	Rock	302.77	22.88
NS	Strub	844.14	63.80
NW	Wetlands	108.85	8.23
OMMB	Man Made Beach	67.30	5.09
	Total	1,323.06	100.00
	Natural	1,255.76	94.91
	Altered	67.30	5.09
	Structures	9.50	0.72

Legend

backlotnutmap by Backlot

- NFM (3)
- NFT (2)
- NW (1)
- YLB (1)
- YLU (2)

Backlot Area and Percentages

Backlot	Type	Area_m2	Percent
NFM	Mixed Forest	19,206.62	69.44
NFT	Thinned Forest	3,556.09	12.86
NW	Wetlands	920.78	3.33
YLB	Buffered Lawn	1,085.32	3.92
YLU	Un-buffered Lawn	2,892.42	10.46
	Total	27,661.23	100.00
	Natural	20,127.40	72.76
	Altered	7,533.83	27.24