

Longline Lake Land Use Survey, July 2007

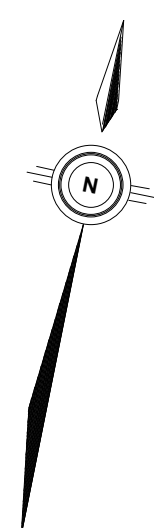
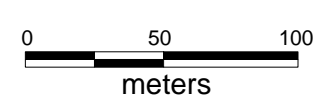
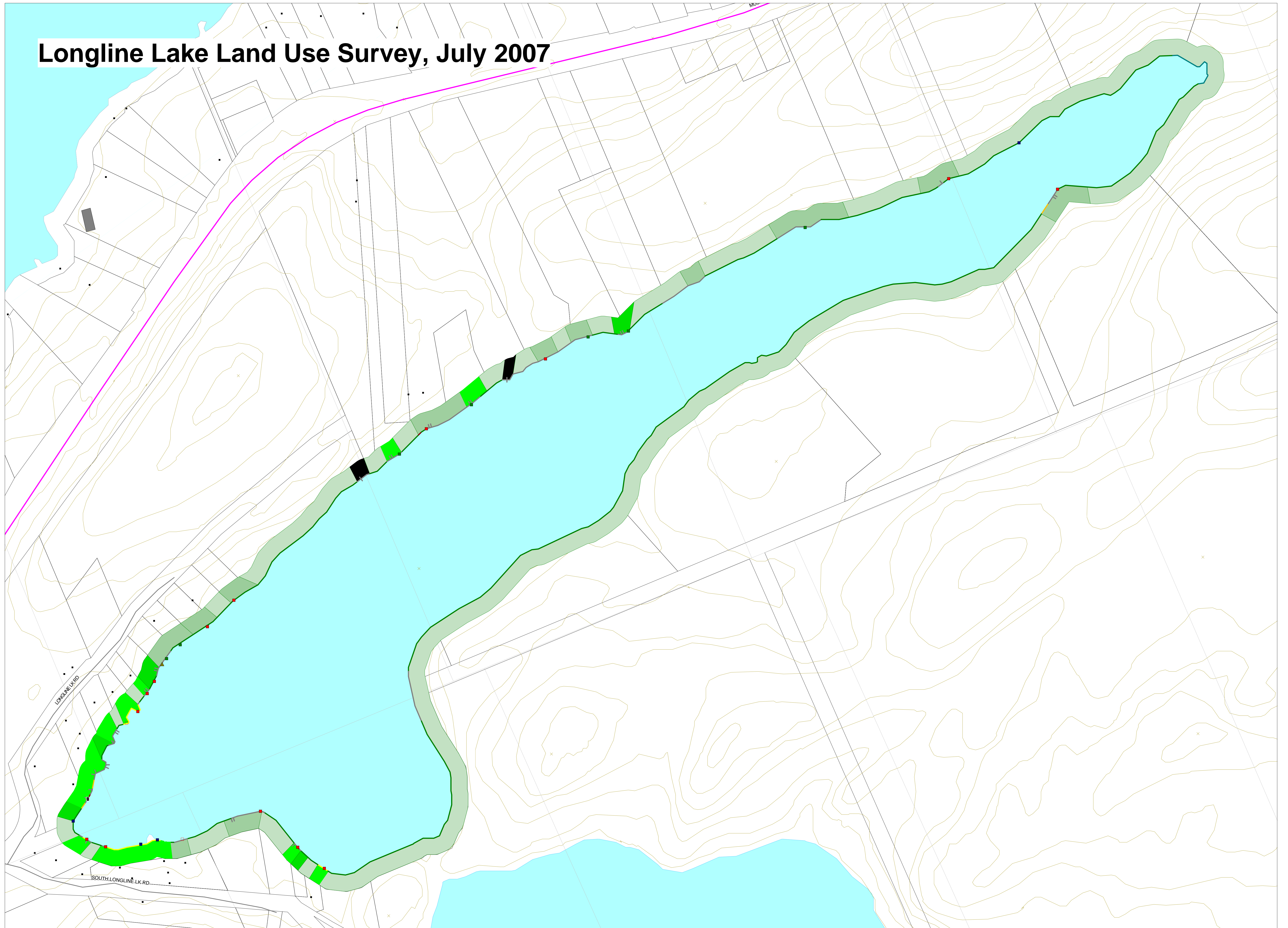

Legend

structureslonglineMAP by Structure_2

- DC (14)
- DC1 (2)
- DPL (4)
- DP (7)
- OSD (1)
- ▲ RW (1)

Structure Count

Structure	Type	Count
DC	Crib Dock	14
DC1	1 Slip Crib Dock	2
DPL	Floating Dock	4
DP	Pole Dock	7
OSD	Deck1	1
RW	Wooden Ramp	1
Total		29

Legend

shorelinelonglineMAP by Shoreline

- NB (3)
- NR (8)
- NS (23)
- NW (1)
- OMMB (4)
- RS (2)
- SWS (19)
- SWW (3)
- YLU (1)

Shoreline Length and Percentages

Shoreline	Type	Length_m	Percent
NB	Beach	32.84	0.85
NR	Rock	411.27	10.70
NS	Shrub	2,877.48	74.90
NW	Wetlands	81.49	2.12
OMMB	Man Made Beach	136.11	3.54
RS	Stone/Gravel Ramp	27.24	0.71
SWS	Stone Shore Wall	250.47	6.52
SWW	Wood Shore Wall	12.04	0.31
YLU	Unbuffered Lawn	12.86	0.34
Total		3,841.90	100.00
Natural		3,403.08	88.58
Altered		438.82	11.42
Structures		102.00	2.65

Legend

backlotlonglineMAP by Backlot_2

- NFM (20)
- NFT (10)
- NO (2)
- OR (2)
- YLB (5)
- YLU (10)

Backlot Area and Percentages

Backlot	Type	Area_m2	Percent
NFM	Mixed Forest	56,780.85	73.24
NFT	Thinned Forest	9,684.77	12.49
NO	Overgrowth	1,425.32	1.84
OR	Road	709.50	0.92
YLB	Buffered Lawn	2,103.50	2.71
YLU	Unbuffered Lawn	6,827.24	8.81
Total		77,531.18	100.00
Natural		56,780.85	73.24
Altered		20,750.33	26.76

Produced by the District of Muskoka under license from Ontario Ministry of Natural Resources, Copyright © Queen's Printer 2006.

The information contained herein may be erroneous, inaccurate or misleading. The parties compiling and/or disclosing the information make no warranties, whatsoever as to the accuracy of any or all of the information contained herein.

Any party relying on this information does so at their own risk and shall not, under any circumstances, make any claim against anyone on the grounds that the information was erroneous, inaccurate or misleading.

This road network information has been generated or adapted from Ontario Road Network Database, a database built from source data provided by the Municipalities of Ontario to the Government of Ontario under license. The Ontario Road Network Database is the property of the Government of Ontario and is used under license from the Government of Ontario.