

Bruce Lake Land Use Survey, June 2005

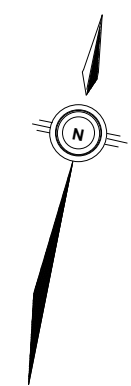
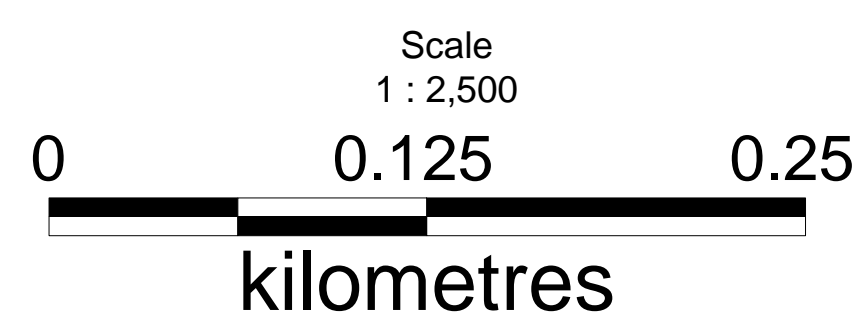
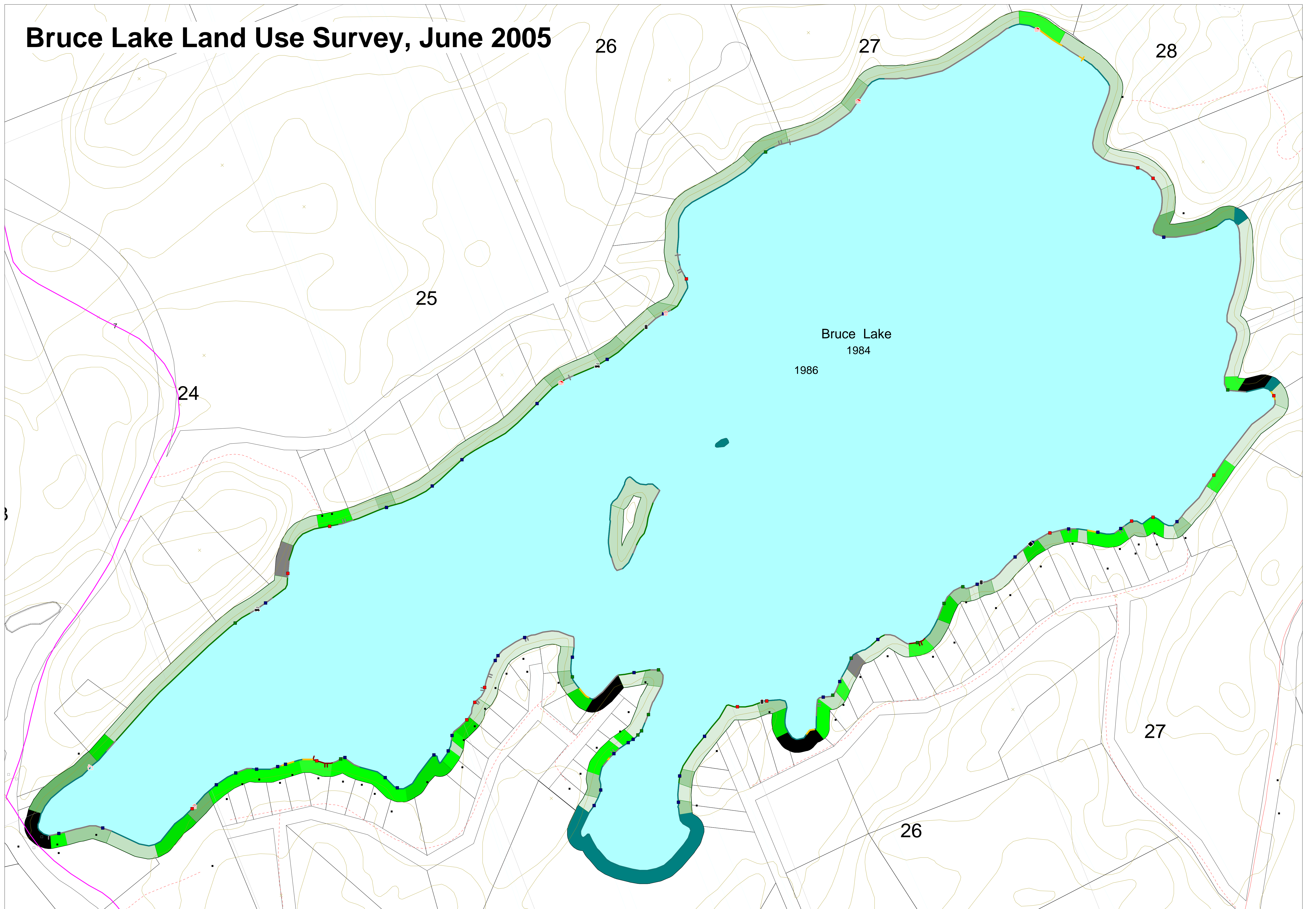

Structure Count

Structure_2	Type	Count
BHC	Crib Boathouse	1
BHC1	1 Slip Crib Boathouse	2
BHC2	2 Slip Crib Boathouse	3
DC	Crib Dock	17
DFL	Floating Dock	44
DP	Pole Dock	14
OMR	Marine Railway	2
OSD	Deck	3
OSOTH	Other	1
	Total	87

Shoreline Length and Percentages

Shoreline_2	Type	Length_m	Percent
NB	Beach	149.85	2.25
NR	Rock	2,437.37	36.59
NS	Shrubs	1,348.55	20.25
NW	Wetland	2,372.48	35.62
RN	Natural Ramp	10.39	0.16
RS	Stone Ramp	35.49	0.53
SWS	Stone Shore Wall	248.89	3.73
SWW	Wood Shore Wall	58.17	0.87
	Total	6,660.99	100.00
	Natural	6,308.25	94.70
	Altered	352.74	5.30

Backlot Area and Percentages

Backlot	Type	Area_m2	Percent
NFC	Coniferous Forest	25,390.01	19.32
NFD	Deciduous Forest	6,283.78	4.78
NFM	Mixed Forest	47,007.78	35.78
NFT	Thinned Forest	10,245.54	7.80
NO	Overgrowth	3,181.95	2.42
NR	Rock	1,615.39	1.23
NW	Wetland	7,401.74	5.63
OR	Road	4,842.62	3.69
YL	Landscaped Yard	5,071.21	3.86
YLB	Buffered Lawn	7,475.99	5.69
YLU	Unbuffered Lawn	12,870.08	9.80
	Total	131,386.09	100.00
	Natural	87,698.70	66.75
	Altered	43,687.39	33.25

Legend

structuresbrucemap by Structure_2	shorelinebrucemap by Shoreline_2	backlotbrucemap by Backlot_2
BHC (1)	NB (8)	NFC (16)
BHC1 (2)	NR (26)	NFD (3)
BHC2 (3)	NS (11)	NFM (20)
DC (17)	NW (27)	NFT (16)
DFL (44)	NO (3)	NO (3)
DP (14)	OR (1)	NR (2)
OMR (2)	RS (3)	NW (4)
OSD (3)	SWS (10)	OR (4)
OSOTH (1)	SWW (2)	YL (6)
		YLB (8)
		YLU (12)

Produced by the District of Muskoka under licence from Ontario Ministry of Natural Resources, Copyright (c) Queens Printer 2006

The information contained herein may be erroneous, inaccurate or misleading. The parties compiling and/or disclosing the information make no warranties whatsoever as to the accuracy of any or all of the information contained herein.

Any party relying on this information does so at their own risk and shall not, under any circumstances, make any claim against anyone on the grounds that the information was erroneous, inaccurate or misleading.