

Brandy Lake Land Use Survey, June 2002

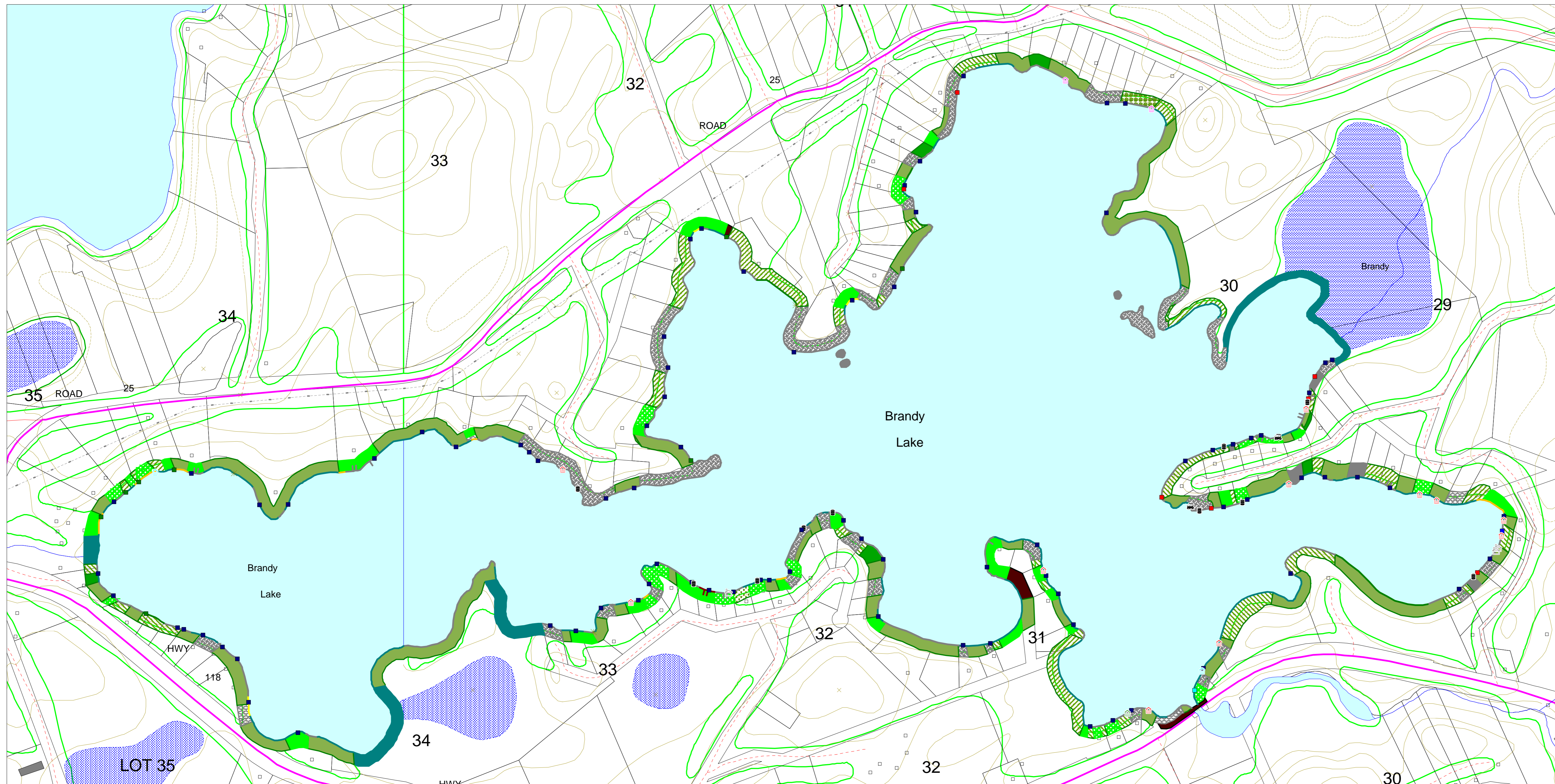

Structures by Type

- BHC1
- BHL1
- BHOTH1
- BHP1
- DC
- DF
- DFL
- DOTH
- DP
- NBL
- OMR
- OSD
- OSS

Shoreline by Type

- NB
- NFC
- NFD
- NFM
- NR
- NW
- OMMB
- RC
- SWS
- SWW

Backlot by Type

- NFC
- NFD
- NFM
- NO
- NR
- NRB
- NS
- NW
- OR
- SWS
- YL
- YLB
- YLU

Code	Type	Area (m2)	Back Lot Percent
NFC	Coniferous Forest	15,262.12	7.68
NFD	Deciduous Forest	20,556.33	10.35
NFM	Mixed Forest	73,632.87	37.07
NO	Overgrowth	628.506	0.32
NR	Natural Rock	2,774.05	1.40
NRB	Natural Rock Barren	34,368.32	17.30
NS	Natural Shrub	1,321.72	0.67
NW	Natural Wetland	13,256.2	6.67
OR	Road	2,266.1	1.14
SWS	Stone Shorewall	2,216.62	1.12
YL	Yard Landscaped	10,911.14	5.49
YLB	Yard Lawn Buffered	3,170.33	1.60
YLU	Yard Lawn Un-Buffered	18,255.97	9.19
	Total	198,620.28	100.00
		0	0.00
	Natural	161,171.61	81.15
	Altered	37,448.67	18.85

Shoreline	Type	Length_m	Percent
NB	Natural Beach	226.92	2.11
NFC	Natural Forest Coniferous	71.72	0.67
NFD	Natural Forest Deciduous	91.47	0.85
NFM	Natural Forest Mixed	219.99	2.04
NR	Natural Rock	5,615.81	52.12
NW	Natural Wetland	4,122.96	38.26
OMMB	Man Made Beach	81.88	0.76
RC	Ramp Concrete	8.76	0.08
SWS	Shore Wall Stone	308.26	2.86
SWW	Shore Wall Wood	27.51	0.26
	Total	10,775.28	100.00
	Structures	500.10	4.64
	Natural	10,348.87	96.04
	Altered	426.41	3.96

Structure	Type	Count
BHC1	Boathouse, crib, one slip	11
BHL1	Boathouse, land, one slip	2
BHOTH1	Boathouse, other, one slip	2
BHP1	Boathouse, pillar, one slip	1
DC	Dock, crib	8
DF	Dock, fill	1
DFL	Dock, floating	85
DOTH	Dock, other	1
DP	Dock, pillar	8
NBL	Natural beaver lodge	3
OMR	Marine railway	2
OSD	Deck	10
OSS	Shed	3
	Total	137

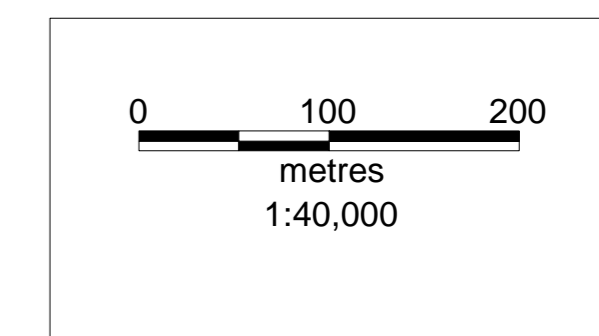
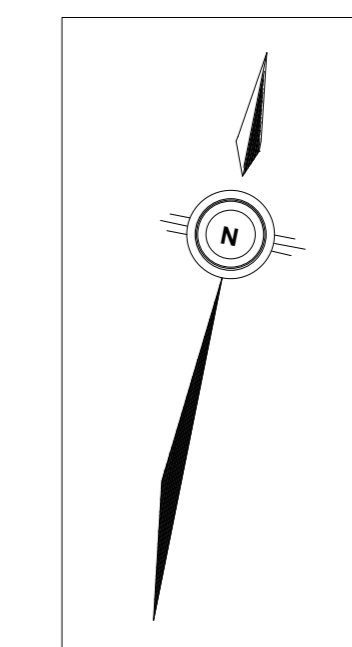

Produced by the District of Muskoka under licence from Ontario Ministry of Natural Resources, Copyright (c) Queens Printer 2004

The information on this map is supplied without expressed or implied warranty of any kind, including any warranty of fitness for a particular purpose.

In no event will the District Municipality of Muskoka be liable for any damages whether incidental, consequential or direct in conjunction with, or arising from the furnishing or use of this information.